

An ISO 9001 : 2015 Certified Company



TRUTEK FASTENERS PVT. LTD.



**YOUR TRUSTED
PARTNER IN
CONSTRUCTION
BUSINESS**

PRODUCT CATALOGUE

info@trutek.co.in | www.tfplindia.com



About TFPL (Trutek Fasteners Pvt. Ltd.)

Who are we?

Trutek Fasteners Pvt. Ltd. is originally a part of an International holding group that includes production and trading companies operating in all parts of the world. Its distribution activity began in Europe in January 2002.

Our company specializes in the production of top quality fastening systems for construction and industry. In our wide range, you will find both traditional products used for many years in the construction industry, and innovative, technologically advanced solutions which will enhance the level of safety, as well as easy and prompt applications.

TFPL in India was formed in the year 2011 and belongs to the Indian management since its inception. The aim of the company has been to compete with established brands and emerge as a strong alternative in the minds of the customers in construction and fabrication fields.

We have a strong sales representation along with a comprehensive product portfolio which helps us to connect with our customers closely, understand their requirement and help them achieve their goals. Our customers are from various fields like Facade, Roofing, Solar, Elevators, Defense, Roads, Infrastructure, uPVC & Aluminium Door & Windows fabricators, construction projects etc.

Top quality of products - technical approvals, certificates and tests

Our products are subject to strict and demanding quality control that ensures the highest quality of the products and complete safety of their use. This is confirmed by numerous certificates and technical approvals.

Fast and complete deliveries

- stock on hand. Advanced SAP computer system enables us to manage warehouse stock accurately and prevent product shortage.
- Prompt order execution. Orders from our Customers, regardless of the way of their submission, are immediately passed on for execution, so we guarantee delivery within 4 hours from ordering.
- Complete delivery information. The integration of our computer system with the shipment system of the forwarding company makes it possible to track the process of shipment online and predict the time of delivery.
- Delivery completeness. The process of the execution of orders involves checking mechanisms that provide multi-level inspection of delivery completeness, thus limiting possible mistakes.

Training

- Product training - it gives the opportunity to get fully familiar with our products, their technical characteristics and applications in construction site conditions.
- Technical training - it includes expertise in the range of materials science, physical and chemical processes that occur during anchoring and product documentation required on construction sites, such as technical approvals, certificates and declarations of conformity.

Technical assistance, advising on construction sites

Technical assistance is provided by a group of experts whose mission is to support design engineers and constructors in cases of innovative and difficult construction projects, as well as the optimum and complex choice of fastenings for typical applications that are common for construction sites:

- telephone info-line technical support,
- choice of fastenings for a given project,
- anchors choice reports,
- materials for design engineers,
- anchors choice program,
- construction site test and presentations.

FIXING
TECHNOLOGY

CONTENTS

Chemical Anchor - T 360 SF	05
Chemical Anchor - T 585 PE & T 385 PE	06
Chemical Anchor Threaded Rods	07
Concrete Screws	08
Through Bolt Anchor	09-10
Sleeve Anchor with Countersunk Bolt Version	11-12
Metal Frame Anchor	13
Metal Hit Anchor	14
Drop in Anchor	15
Drill Bits - SDS Hammer	16
Roofing Screw (Galvanised and ruspert coated)	17
Nylon Window Frame Anchor	19
Self Drill Screws	20
Window Screws / PVC Screws	21
Stainless Steel Screws - 304 (A2) / 316 (A4)	22
Fastener Cap / Weather Strip	23
Profile Packer / Glass & Sliding Glass Packer	24
Handle Screws / Mechanical L – Joint / Bump Stopper / Drainage Cap	25
Sliding Fix Stopper / Midway Seal / Antilift / Fix Stopper	26

An ISO 9001 : 2015 Certified Company



CUSTOMER SEGMENTS



uPVC Window



uPVC Door



Solar



Residential & commercial construction projects



Façade



Roofing



Infrastructure



Elevators

CHEMICAL ANCHOR - T 360 SF

Chemical anchor TFPL T360 SF is a special resin which is vinylester styrene free. It is high performance rapid curing, low odour two component chemical anchor injection system. It is suitable for medium to high load applications in virtually all cases.

Base Material: Non-cracked concrete of min. C20/25 clas.

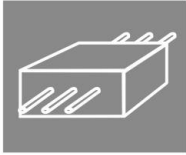

Pack Size
12 pcs.



Applications

- bonding of threaded and reinforcement bars into concrete, reinforced concrete and natural stone,
- anchoring of any kind of structures and appliances,
- installation of railings and balustrades,
- installation of garage and entrance gateways.

Advantages

- no reaction with chemicals and water after curing,
- two resin components contained in a single popular 360 ml cartridge,
- odourless - contains no styrene,
- high reactivity, facilitating penetration into base material
- wide range of TCS type anchoring bars, cold galvanized and oven coated steel, as well as stainless steel.

Resin T 360 SF and threaded bars TCS of class 5.8 steel in concrete

Resin / anchor bar type	T 360 SF / threaded bar TCS, class 5.8 steel					
Threaded rod diameter d (mm)	M8	M10	M12	M16	M20	M24
Calculated tensile capacity N_{Rd} (kN)	12	15.5	21.5	32	50	80
Calculated shearing capacity V_{Rd} (kN)	7.2	12	16.8	31.2	48.8	70.4
Hole diameter / drill diameter d_0 (mm)	10	12	14	18	22	26
Hole depth h_i (mm)	85	95	115	130	175	245
Effective embedment h_{ef} (mm)	80	90	110	125	170	240
Base material thickness h_{min} (mm)	110	120	140	164	214	292
Minimum anchor spacing $S_{cr,sp}$ (mm)	35	40	50	65	85	96
Required tightening Torque T_{inst} (Nm)	10	20	40	80	150	200
Minimum Edge Distance $C_{cr,sp}$ (mm)	35	40	50	65	85	96
Approximate amount of resin per hole (ml)	5	8	13	25	50	98
Number of fastening from one 360 ml cartridge	72	45	27	14	7	4

The technical data of Trutek T 360 SF are based on the strength performance of C20/25 concrete (acc. PN-EN 206-1:2003 standard)

Resin T 360 SF and reinforcement bars Bst500, acc. to DIN 488, in concrete

Resin / anchor bar type	T 360 SF / reinforcement bar Bst500 acc. to DIN 488					
Bar diameter d (mm)	Ø8	Ø10	Ø12	Ø16	Ø20	Ø25
Calculated tensile capacity N_{Rd} (kN)	8.3	11.7	17.2	23.2	34.6	47.7
Calculated shearing capacity V_{Rd} (kN)	11.1	17.3	24.9	44.2	69.1	108
Hole diameter / drill diameter d_0 (mm)	12	14	18	22	28	32
Hole depth h_i (mm)	85	95	115	130	175	245
Effective embedment h_{ef} (mm)	80	90	110	125	170	250
Base material thickness h_{min} (mm)	100	120	140	170	220	292
Minimum anchor spacing $S_{cr,N}$ (mm)	35	40	50	65	85	96
Required tightening torque T_{inst} (Nm)	35	40	50	65	85	96
Minimum Edge Distance $C_{cr,sp}$ (mm)	80	90	110	125	170	270
Approximate amount of resin per hole (ml)	7.2	11	17.3	31.3	64.4	153.8
Number of fastening from one 360 ml cartridge	50	32	21	11.5	5.50	2.30

The technical data of Trutek T 360 SF are based on the strength performance of C20/25 concrete (acc. PN-EN 206-1:2003 standard)

Dispenser TCM 300MT



Mixer nozzle TCN01
and extension nozzle TEN01



Hole cleaning brush TCB
and debris blow-out pump TBP



T 585 PE & T 385 PE are a very high strength market dominating and high performance premium grade solvent free pure epoxy based chemical injection systems for heavy duty structural applications. Available in pack size of 585ml & 385 ml Respectively.

Base Material: Cracked & Uncracked concrete of min. C20/25 class.

Suitable for Sismic Environment (C1 & C2) Compliant

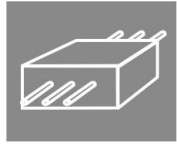

Pack Size 12 pcs.



Applications

- bonding of threaded and reinforcement bars into concrete, reinforced concrete, natural stone & brick works.
- anchoring of any kind of building structures and load carrying posts,
- underwater fastenings in maritime and inland port structures, sewage treatment and water conditioning plants,
- anchoring in diamond drilled holes.

Advantages

- extreme load capacity in both cracked & uncracked concrete,
- no reaction with chemicals and water after curing,
- WRAS technical approval, permitting use of in food industry-contact with drinking water,
- odourless – contains no styrene,
- prolonged gelation and bonding time, enabling deep bonding of threaded and reinforcement bars,
- wide range of TCS type anchoring bars, cold galvanized and hot-dip coated steel, as well as A4 stainless steel.
- suitable for seismic environment.

Resin T 585 PE & T 385 PE and threaded road TCS – class 5.8 steel



Resin / anchor bar type	T 585 PE & T 385 PE / threaded bar TCS, class 5.8 steel						
Threaded bar diameter d (mm)	Ø8	Ø10	Ø12	Ø16	Ø20	Ø20	Ø30
Calculated tensile capacity N_{Rd} (kN)	7.3	18.85	23.69	36.76	61.03	98	148
Calculated shearing capacity V_{Rd} (kN)	7.2	12	16.8	31.2	48.8	70.4	112
Hole diameter / drill diameter d_0 (mm)	10	12	14	18	22	26	35
Hole depth h_1 (mm)	85	95	115	130	175	215	300
Effective embedment h_{ef} (mm)	80	90	110	125	170	210	295
Base material thickness h_{min} (mm)	110	120	130	164	214	262	370
Minimum anchor spacing $S_{cr,N}$ (mm)	160	180	220	250	340	420	600
Required tightening torque T_{inst} (Nm)	10	20	40	80	135	200	270
Minimum Edge Distance $C_{cr,N}$ (mm)	80	90	110	125	170	210	300
Approximate amount of resin per hole (ml)	5	8	13	25	50	98	198
Number of fastening from one 585 ml cartridge	117	73	44	23	12	6	3

The technical data of Trutek T585 PE & T 385 PE are based on the strength performance of C20/25 concrete (acc. to PN-EN 206-1:2003 standard).

Resin T 585 PE & T 385 PE and reinforcement bars BSSt500 acc. to DIN 488

Resin / anchor bar type	Resin T 585 PE & T 385 PE and reinforcement bars BSSt500 acc. to DIN 488						
Bar diameter d (mm)	Ø8	Ø10	Ø12	Ø16	Ø20	Ø25	Ø32
Calculated tensile capacity N_{Rd} (kN)	9.9	18.85	23.69	39.83	66.12	102.1	186.70
Calculated shearing capacity V_{Rd} (kN)	11.1	17.2	24.8	44.4	69.2	108	176.80
Hole diameter / drill diameter d_0 (mm)	12	14	16	20	25	32	40
Hole depth h_1 (mm)	85	95	115	130	175	215	305
Effective embedment h_{ef} (mm)	80	90	110	125	170	210	300
Base material thickness h_{min} (mm)	100	120	140	170	220	270	400
Minimum anchor spacing $S_{cr,N}$ (mm)	160	180	220	250	340	420	600
Required tightening torque T_{inst} (Nm)	10	20	40	80	135	200	270
Minimum Edge distance $C_{cr,sp}$ (mm)	80	90	110	125	170	210	300
Approximate amount of resin per hole (ml)	7.2	11	17.3	31.3	64.4	153.8	287.5
Number of fastening from one 585 ml cartridge	81	53	34	19	9	4	2

The technical data of Trutek T 585 PE & T 385 PE are based on the strength performance of C20/25 concrete (acc. to PN-EN 206-1:2003 standard).

Dispenser TCM 400MT



Mixer nozzle TCN02 and extension nozzle TEN01



Hole cleaning brush TCB and debris blow-out pump TBP



CHEMICAL ANCHOR THREADED RODS

TFPL's threaded rods are widely used product in many industrial, construction, maintenance and even in home use. TCS series is specially developed to suit with the chemical resins T 350 SF & T 385 PE. Available in galvanized 5.8 grade in all standard sizes. Stainless steel version 304 (A2) & 316 (A4) also available on special requests.



Product Code	Drill Diameter (mm)	Drill Length (mm)	Box Packing	Bulk Packing
TCS0010130G	10	130	1	30
TCS0010160G	10	160	1	30
TCS0010165G	10	165	1	30
TCS0012160G	12	160	1	20
TCS0012220G	12	220	1	20
TCS0012250G	12	250	1	20
TCS0016135G	16	135	1	10
TCS0016165G	16	165	1	10
TCS0016190G	16	190	1	10
TCS0016250G	16	250	1	20
TCS0016300G	16	300	1	10
TCS0016380G	16	380	1	10
TCS0016500G	16	500	1	10
TCS0020260G	20	260	1	10
TCS0020350G	20	350	1	10
TCS0020500G	20	500	1	10
TCS0024300G	24	300	1	10
TCS0024400G	24	400	1	5
TCS0024550G	24	450	1	5
TCS0024750G	24	750	1	5
TCS00303080G	30	380	1	5
TCS0030500G	30	500	1	5

Calculated tensile capacity of threaded bars TCS of class 5.8 steel in C20/25 concrete, in kG

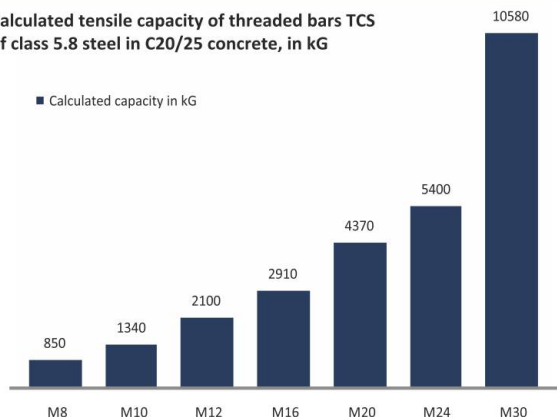

Calculated tensile capacity of reinforcement bars BSt500 in C20/25 concrete, in kG

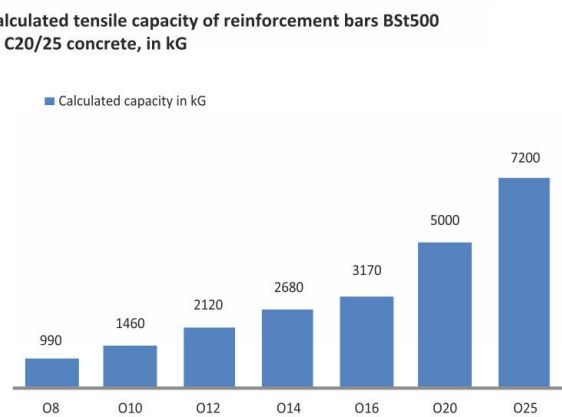

Sleeve Material: Screw made of regular class 8.8 carbon steel with upto 5 mm zinc coating.
 Base Material: Concrete, ceramic solid brick, cavity brick, lime-sand solid and cavity brick, lightweight concrete, aerated concrete.

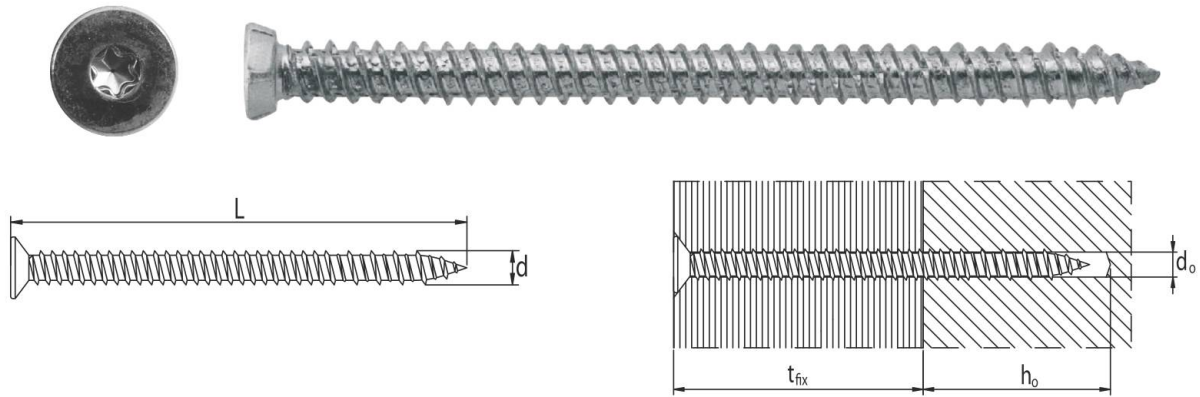

Applications

- Metal fastening of door and window casing,
- Fastening of door and window frames,
- Fastening of fire resistant doors,
- Fire resistant fastening of cabling,
- Fastening of wood strips.

Advantages

- Small hole diameter,
- full-length thread prevents frame motions to/from base,
- Non-flammable fastening.

Product code	Sleeve diameter [mm] d	Hole diameter [mm] d _o	Min hole depth [mm] h _o	Sleeve length [mm] L _o	Max. thickness of fixed element [mm] t _{fix}	Max tightening torque [mm] T _{inst}	TORX Drive	Recommended tensile and shear capacity N _{rec}				
								Concrete C20/25 [kN] N _{rec}	Solid brick [kN] N _{rec}	Lime-sand brick [kN] N _{rec}	Light concrete [kN] N _{rec}	Aerated concrete [kN] N _{rec}
TFCS7572	7.5	6	30	72	40	15	T30	3.0	2.5	2.5	2.5	0.4
TFCS7582	7.5	6	30	82	50	15	T30	3.0	2.5	2.5	2.5	0.4
TFCS7592	7.5	6	30	92	60	15	T30	3.0	2.5	2.5	2.5	0.4
TFCS75102	7.5	6	30	102	70	15	T30	3.0	2.5	2.5	2.5	0.4
TFCS75112	7.5	6	30	112	80	15	T30	3.0	2.5	2.5	2.5	0.4
TFCS75122	7.5	6	30	122	90	15	T30	3.0	2.5	2.5	2.5	0.4
TFCS75132	7.5	6	30	132	100	15	T30	3.0	2.5	2.5	2.5	0.4

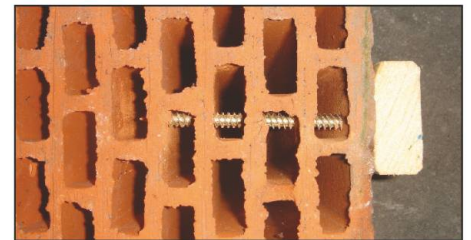
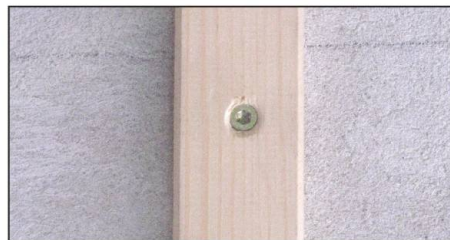

TFCS screw installation scheme

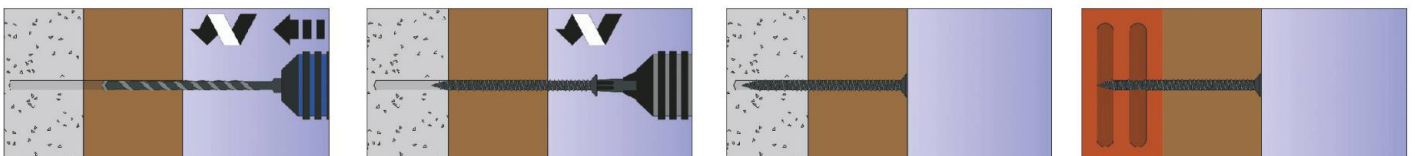

THROUGHBOLT - TBA - SEGMENT ANCHOR

Throughbolt TBA anchors are made of regular carbon steel of the mechanical property class 4.8 acc. to PN-EN ISO 898-1:2001 standard, with min. 5mm zinc coating.

Base Material: Non-cracked concrete of min. C20/25 class.

Applications

- designed for medium load fastenings of construction elements, elevations, barriers, railings etc.
- fastening of storehouse shelving,
- fastening of construction elements and installations to cracked concrete floors
- basic anchor for fastening all kinds of installations.



Advantages

- the same anchor for use in non-cracked and cracked concrete,
- easy and simple installation
- wide product line: cold galvanized and hot-dip coated steel, as well as A4 stainless steel.

Recommended tensile strengths in kG



TT anchor designation

Trutek Throughbolt	Thread size d [mm]	Anchor length L [mm]
TBA	06	045

Technical specification of TBA anchors

Product code	Thread Size M [mm]	Anchor length	Hole Dia. d ₁ [mm]	Min hole depth	Minimum anchor embedment	Min base thickness h _{min} [mm]	Max thickness of fixed element [t _{fix}]	Min hole dia in fixed element [d _{mm}]	Pack Size
TBA08075G	8	75	8	60/45*	50/35*	100	20/35*	10	75/750
TBA08100G	8	100	8	60/45*	50/35*	100	45/65*	10	50/500
TBA1075G	10	75	10	70/60*	55/45*	110	15/25*	12	50/400
TBA10100G	10	100	10	70/60*	55/45*	110	40/50*	12	50/500
TBA10125G	10	125	10	70/60*	55/45*	110	75/65*	12	25/200
TBA10150G	10	150	10	70/60*	55/45*	110	90/100*	12	25/250
TBA12100G	12	100	12	90/70*	70/50*	140	25/45*	14	25/200
TBA12125G	12	125	12	90/70*	70/50*	140	50/70*	14	25/200
TBA12150G	12	150	12	90/70*	70/50*	140	70/90*	14	25/200
TBA16125G	16	125	16	110/90*	85/65*	170	35/5*	18	15/120
TBA16150G	16	150	16	110/90*	85/65*	170	60/80*	18	10/80
TBA16190G	16	190	16	110/90*	85/65*	170	100/120*	18	15/90
TBA16200G	16	200	16	110/90*	85/65*	170	110/130*	18	10/60
TBA20150G	20	150	20	130/110*	100/80*	200	45/65*	22	5/40
TBA20200G	20	200	20	130/110*	100/80*	200	100/120*	22	5/30

* Values for reduced anchor embedment



Mechanical properties of TT anchors

Thread Size	M6	M8	M10	M12	M16	M20	M24
f_{uk} (N/mm ²) Nominal tensile capacity	600	600	600	600	600	600	600
f_{yk} (N/mm ²) Nominal yield stress	480	480	480	480	480	480	480
A_s (mm ²) Effective cross section	20.1	36.6	58.0	84.3	157.0	245.0	353.0
W_{ej} (mm ³) Sectional modulus	12.7	31.2	62.3	109.2	277.5	540.9	935.5
M_{rks}^0 (Nm) Characteristic bending moment	9.2	22.5	44.9	78.6	199.8	389.4	673.5

Calculated load capacity of TT anchors in C20/25 concrete for nominal embedment h_{ef}

Anchor size symbol	TT M6	TT M8	TT M10	TT M12	TT M16	TT M20	TT M24
Effective anchor embedment f_{uk} [mm]	40	50	55	70	85	100	130
Tensile capacity N_{rec} [kN] – non-cracked C20/25 concrete	1.95	4.20	5.90	10.30	20.10	21.65	29.85
Tensile capacity N_{rec} [kN] – cracked C20/25 concrete	0.55	3.20	4.25	6.90	12.50	16.00	23.70
Shear capacity V_{rec} [kN] – non-cracked C20/25 concrete	1.45	2.70	3.85	16.85	31.40	49.00	70.60
Shear capacity V_{rec} [kN] – cracked C20/25 concrete	0.55	3.20	4.25	6.90	12.50	16.00	23.70
Anchor spacing $S_{cr,N}$ [mm]	120	150	165	210	255	300	390
Edge distance $C_{cr,N}$ [mm]	60	75	85	105	130	150	195
Required tightening torque T_{inst} [Nm]	7	10	30	50	100	180	300

Calculated load capacity of TT anchors in C20/25 concrete for reduced embedment $h_{ef,red}$

Anchor size symbol	TT M6	TT M8	TT M10	TT M12	TT M16	TT M20	TT M24
Effective anchor embedment h_{ef} [mm]	30	35	45	50	65	80	100
Tensile capacity N_{rec} [kN]	1.30	2.40	4.40	6.20	13.40	15.50	20.10
Tensile capacity V_{rec} [kN]	1.45	2.70	3.85	16.85	31.40	49.00	70.60
Anchor spacing $S_{cr,N}$ [mm]	90	105	135	150	195	240	300
Edge distance $C_{cr,N}$ [mm]	45	55	70	75	100	120	150
Required tightening torque T_{inst} [Nm]	7	10	30	50	100	180	300

IT anchor installation

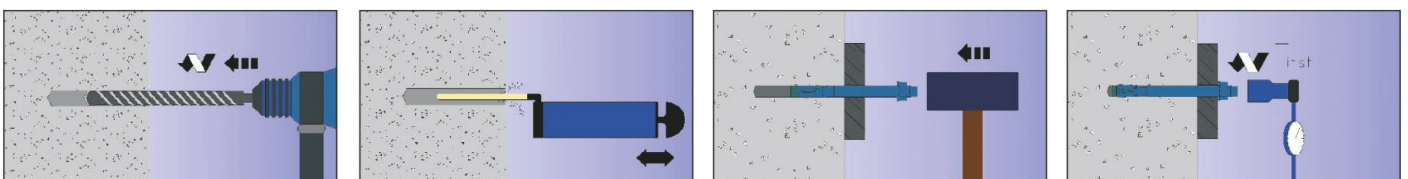

▶ TSA - SLEEVE ANCHOR WITH COUNTERSUNK BOLT VERSION

Anchor bar material: TSA expansion anchor sleeves and threaded bolts are made of regular carbon steel of the mechanical property class 5.8 with min. 5µm zinc coating

Base material: Non-cracked concrete of min. C20/25 class, solid brick of min. 15 class.

Applications

- the sleeve anchor is an all steel, thin walled, through fixing for general purpose applications for example, fastening of air conditioners, railings, staircase, glass fitting work etc.
- suitable for fixing into concrete, solid brick, dense blockwork and some natural stone,
- finish available: white zinc plated min 5µm countersunk

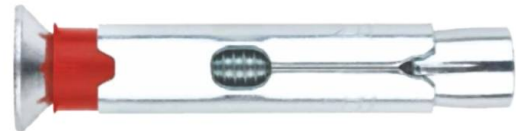

Advantages

- metal anchor that works by expansion once installed with controlled torque,
- flat head screw, male thread, easy assembly,
- specially shaped red cut-outs in the sleeve provide better pressing of fixed material to base material and prevent anchor rotation in the hole.



Technical specification of TSA anchors

Product Code	Thread Diameter (mm)	Drill Hole Diameter (mm)	Anchor Length (mm)	Maximum Fixture Thickness (mm)	Embedment Depth (mm)	Maximum Hole Depth (mm)	Fixture Clearance Hole (mm)	Minimum Structure Thickness (mm)	Tightening Torque (mm)
TSA08045CS-G	6	8	45	5	40	50	9	60	20
TSA08060CS-G	6	8	60	20	40	50	9	60	20
TSA1060CS-G	8	10	60	5	55	60	11	70	40
TSA1080CS-G	8	10	80	25	55	60	11	70	40
TSA1270CS-G	10	12	70	5	65	75	13	80	60
TSA12100CS-G	10	12	100	35	65	75	13	80	60
TSA16080CS-G	12	16	80	15	60	70	17	100	90
TSA16100CS-G	12	16	100	50	60	70	17	100	90
TSA16110CS-G	12	16	110	50	60	70	17	100	90

Installation information

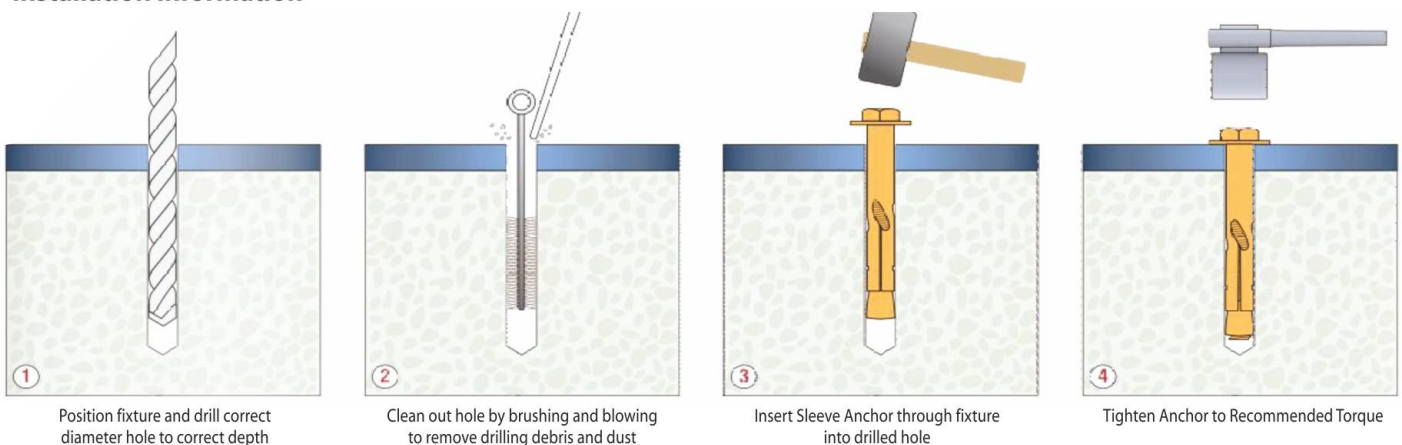

▶ TSA - SLEEVE ANCHOR WITH COUNTERSUNK BOLT VERSION

Performance Data (20/25 Concrete)									
Anchor Diameter mm	Characteristic Resistance kN		Design Resistance kN		Recommended Load kN		Spacing mm	Edge Distance mm	
	Tensile	Shear	Tensile	Shear	Tensile	Shear	Tensile & Shear	Tensile	Shear
8	6.6	4.5	3.1	2.5	2.2	1.8	90	45	80
10	10.2	8.3	4.9	4.6	3.4	3.3	100	50	100
12	12.6	13.3	6.0	7.4	4.2	5.3	130	65	120
16	15.0	19.3	7.1	10.7	5.0	7.7	140	70	160
20	17.7	36.0	8.4	20.0	5.9	14.3	150	75	200

Shear Loads towards a free edge are for single anchors where Spacing $\geq 3 \times$ Edge Distance

Reduced Design Resistance (kN) • Divide Loads by 1.4 for Recommended Loads

Edge Distance (C20/25 Concrete) for single anchors										
Edge mm	Tensile Resistance					Shear Resistance				
	M8	M10	M12	M16	M20	M8	M10	M12	M16	M20
40	2.9									
45	3.1	4.6								
50		4.9	5.0			1.6				
60			5.7	6.4		1.9				
65			6.0	6.7	7.6	2.0				
70				7.1	8.0	2.2	3.2			
75					8.4	2.3	3.5			
80						2.5	3.7	4.9		

Spacing (C20/25 Concrete)					
Edge mm	Tensile Resistance				
	M8	M10	M12	M16	M20
65	5.3				
70	5.5				
75	5.7				
80	5.9	8.8			
85	6.0	9.1			
90	6.2	9.3	10.2		
95		9.6	10.4		
100		9.8	10.6	12.2	

Influence of Concrete Strength

Concrete Strength		C20/25	C25/30	C30/37	C40/50	C45/55	C50/560
Cylinder	N/mm ²	Increased concrete strength factors cannot be used with this anchor					
Cube	N/mm ²						
Factor							

When using concrete factors check all other information to ensure Steel Strength and Pull out Resistance is not exceeded

Steel Design Resistance for single anchor

		M8	M10	M12	M16	M20
Tension	kN	Not Applicable				
Shear	kN					

Anchor Mechanical Properties

		M8	M10	M12	M16	M20
Tensile Strength	N/mm ²	400	400	400	400	400
Yield Strength	N/mm ²	240	240	240	240	240
Nut A/F	mm	10.0	13.0	17.0	19.0	24.0
Washer Diameter	mm	12.0	17.0	21.0	24.0	30.0

Loads for solid Brickwork (20.5N/mm ²)	
Anchor Diameter	Recommended Load kN
M8	1.1
M10	1.5
M12	2.2
M16	2.5

Loads for Concrete Blocks (7N/mm ²)	
Anchor Diameter	Recommended Load kN
M8	0.8
M10	1.0
M12	1.4
M16	1.9

Loads are for any direction

Maintain Spacing as per Concrete Loads but only 1 fixing per brick is recommended

Do not fix closer than 1 brick away from a free edge

Due to the variable nature of Brickwork and Blockwork these figures are for guidance only

For critical applications a site test is recommended

▶ TMFA - DOOR/WINDOW METAL FRAME ANCHOR

Sleeve material: Expansion sleeve made of regular class 8.8 carbon steel with up to 5 µm zinc coating.

Base material: Concrete, natural stone, ceramic solid brick, cavity brick, lime-sand solid and cavity brick, lightweight concrete, aerated concrete.

Applications

- metal fastening of uPVC & Aluminium door and window casing,
- fastening of door and window frames,
- fastening of wood strips.

Advantages

- no frame tightening to base material during installation,
- anchor sleeve cold galvanized up to 3µm, which ensures good corrosion resistance.
- easy installation & secure grip will ensure long lasting fixing.



TMFA anchor designation		
Symbol	Hole diameter d_o [mm]	Anchor Length L [mm]
TMFA	8	112

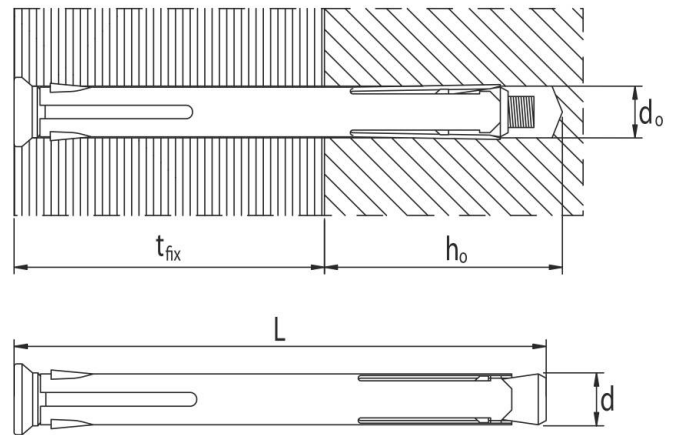

Technical specification of TMFA anchors

Product code	Sleeve diameter [mm] d	Hole diameter [mm] d_o	Min hole depth [mm] h_o	Sleeve length [mm] L_o	Max. thickness of fixed element [mm] t_{fix}	Max. tightening torque [Nm] t_{inst}	Recommended tensile and shear capacity N_{rec}				
							Concrete C20/25 [kN] N_{rec}	Solid brick [kN] N_{rec}	Lime-sand brick [kN] N_{rec}	Light concrete [kN] N_{rec}	Aerated concrete [kN] N_{rec}
TMFA10112	8	8	30	112	82	5	1.5/1.0	1.0/0.5	1.0/0.5	1.0/0.5	0.5/0.5
TMFA10132	8	8	30	132	102	5	1.5/1.0	1.0/0.5	1.0/0.5	1.0/0.5	0.5/0.5

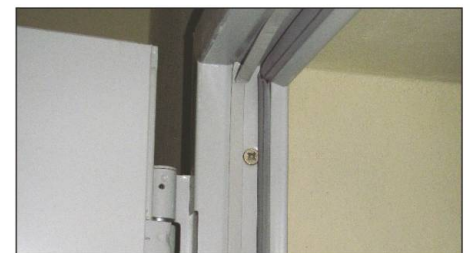

TMFA anchor installation scheme

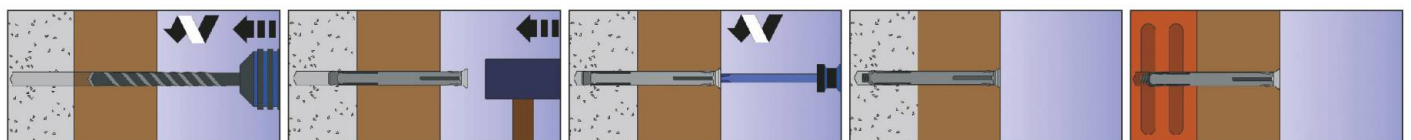

Sleeve material: Expansion sleeve made of zin-aluminium alloy. Nail made of regular carbon steel with min. 5 µm zinc coating.

Base material: Concrete, natural stone, ceramic solid brick, lime-sand solid brick.

Applications

- fastening of metal sheet in roofing works,
- fastening of cabling,
- fastening of band iron to concrete,
- fastening of clamping rings for cables and cable shells,
- fastening of suspended ceiling strips to walls,
- fastening of perforated strap.



Advantages

- fast and easy installation,
- low-cost fastening.

TZH anchor designation		
Symbol	Hole diameter d_o [mm]	Anchor version
TZH	06	050

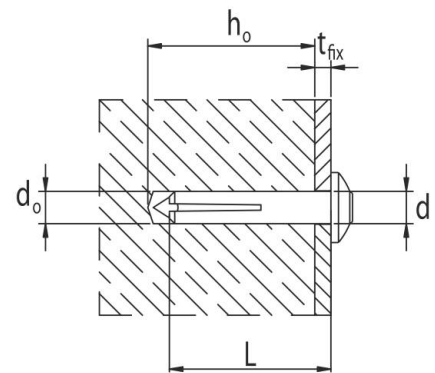
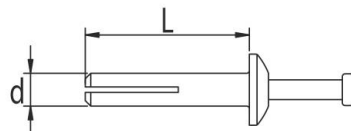
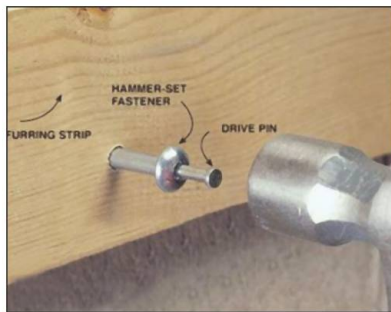

Fastening specification of TZH anchors

Product code	Sleeve diameter [mm] d	Hole diameter [mm] d_o	Min. hole depth [mm] h_o	Anchor length [mm] L	Max. thickness of fixed element [mm] t_{fix}	Recommended tensile and shear capacity N_{rec}		
						Concrete C20/25 [kN] N_{rec}	Solid brick [kN] N_{rec}	Aerated concrete [kN] N_{rec}
TZH06050G	6	6	22	50	28	0.4	0.1	0.1
TZH06065G	6	6	22	65	43	0.4	0.1	0.1

TZH strike anchor installation in concrete

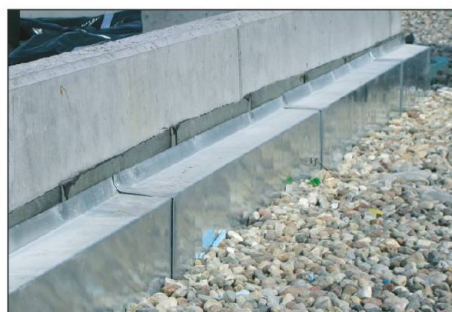
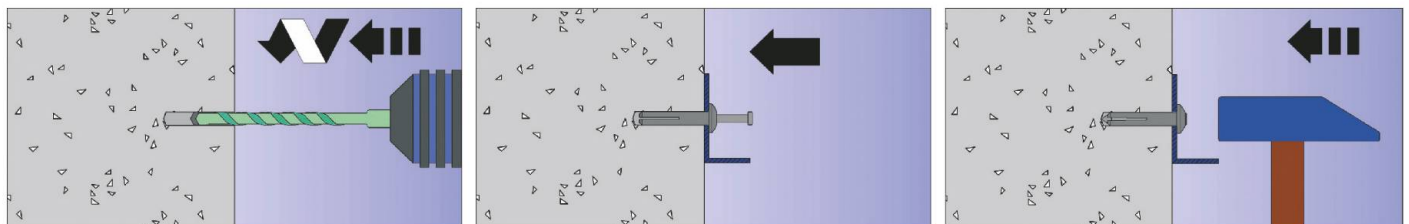

► DROP IN ANCHOR – TDA – INTERNALLY THREADED SLEEVE ANCHOR

TDA and TDA anchors: up to 5mm cold galvanized carbon steel.
Base Material: Non-cracked concrete of min. C20/25 class.



Applications

- fastening of tubing, ventilation, electrical and telecommunication installations,
- fastening and securing of scaffolding and falsework,
- fastening of suspended ceilings and lighting,
- high and medium load capacity with alternative use of bolts or threaded bars.

Advantages

- short embedment – base material thickness from 80 mm,
- sleeve not protruding from base material,
- simple fastening removal,
- flangeless version enables deeper embedment.

TDA anchor designation		
Trutek Drop in Anchor	Thread size d [mm]	Anchor version
TDA	10	L – flanged version
TDA	10	LS – shortened flanged version
TDA	10	- flangeless version

Nośności obliczeniowe tulei TDA na wrywanie z betonu C20/25 w kg

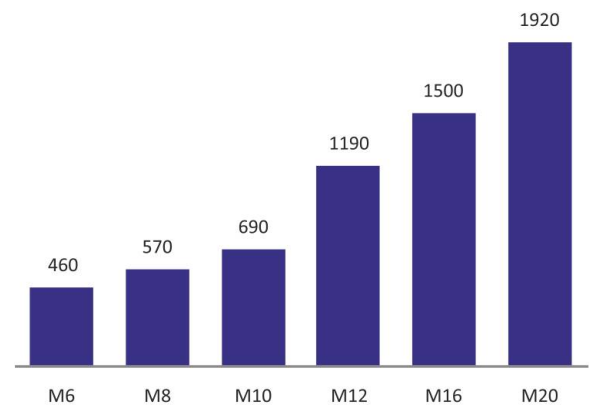

Technical specification of TT anchors

Product code	Thread Size	Hole diameter	Min. hole depth	Effective anchor embedment	Min. base thickness	Min. hole diameter in fixed element	Anchor length	Installation tool
	d [mm]	d _o [mm]	h ₁ [mm]	h _{ef} [mm]	h _{min} [mm]	d _r [mm]	L [mm]	designation
TDA06L/TDA06	6	8	25	25	80	7	25	TDST06
TDA08L/TDA08	8	10	30	30	80	9	30	TDST08
TDA10LS*	10	12	30	30	80	11	30	TDST10
TDA10L/TDA10	10	12	40	40	90	11	40	TDST10
TDA12L/TDA12	12	15	50	50	110	13	50	TDST12
TDA16L/TDA16	16	20	65	65	140	18	65	TDST16
TDA20	20	25	80	80	160	24	80	TDST20

* Shortened version for use in case of reinforcement found near base material surface

Mechanical properties of TDA L and TDA anchors

Thread size	M6	M8	M10	M12	M16	M20
f _{uk} [N/mm ²] - Nominal tensile capacity	520	520	520	520	520	520
f _{yk} [N/mm ²] - Nominal yield stress	400	400	400	400	400	400
A _s [mm ²] - Effective cross section	20.1	36.6	58.0	84.3	157.0	245.0
W _{el} [mm ³] - Sectional modulus	12.7	31.2	62.3	109.2	277.5	540.9

* Recommended load capacity of TDA L and TDA anchors in C20/25 concrete

Anchor size symbol	TDA06	TDA08	TDA10	TDA12	TDA16	TDA20
Effective anchor embedment h _{ef} [mm]	25	30	40	50	65	80
Tensile capacity N _{Rd} [kN]	4.6	5.7	6.9	11.9	15.0	19.2
Shear capacity V _{rec} [kN]	3.6	4.5	5.5	9.4	32.7	51.0
Anchor spacing S _{ct,N} [mm]	80	90	120	150	200	240
Edge distance C _{ct,N} [mm]	40	45	60	75	100	120
Required tightening torque T _{inst} (Nm)	4.5	11	22	38	95	185

* Capacity achievable with bolts or threaded bars made of steel of mechanical properties class not less than 5.8 for threaded products.

Trutek's SDS Drill Bits can drill holes in concrete, ceramics, solid bricks, cavity bricks, lime-sand solid and lightweight concrete etc.



Applications

- drilling in concrete, natural stone and brick,
- drilling of holes for anchors and passes for
- small-diameter cables and pipes.

Advantages

- deep flutes provide optimum removal of debris,
- heavy duty strike resistant tip made of sintered carbide,
- strengthened core ensures high drilling stability,
- perfect quality, drilling speed and reduced vibration of Trutek drill bits.



Tip:

- single-piece blade made of sintered carbide
- shallow nose angle, 160°
- chiselling effect



Spirala:

- narrow side edge reduces drilling resistance
- rounded spiral geometry helps in fast dust removal
- strengthened core ensures optimum transfer of hammering

Product Code	Drill Diameter (mm)	Drill Length (mm)	Box Packing	Bulk Packing
TCP06210	6	210	50	250
TCP65210	6.5	210	25	200
TCP08210	8	210	25	200
TCP10210	10	210	25	200
TCP12210	12	210	30	30

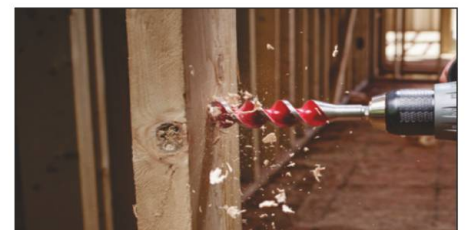

► TRS - ROOFING SCREW (GALVANISED AND RUSPERT COATED)

Trutek TRS roofing screw are used for assembling metal to metal, metal to timber in various combination.

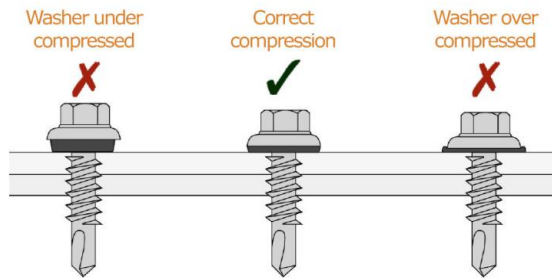

Applications

- used for fixing roofing sheets with metal purlins,
- can also be used to fix standing seam clips,
- can be used to fix roofing sheets onto timber as base material.

Advantages

- grips the sheet with the purlin to securely hold it,
- EPDM washers seals the hole & prevents water to seep through it,
- good cutting blade ensures smooth & faster drilling into the substrate then the average screws locally available.

Product Code	Screw Diameter (mm)	Screw Length (mm)	Box Packing
TRS024819 GT	4.8	19	1000/4000
TRS024819 G	4.8	19	1000/4000
TRS025525 G	5.5	25	1000
TRS025535 G	5.5	35	500/3000
TRS025555 G	5.5	55	1000
TRS025565 G	5.5	65	250/1000
TRS025568 G	5.5	68	250/1000
TRS025575 G	5.5	75	250/1000
TRS0025595 G	5.5	95	1000
TRS00255100 G	5.5	100	100/1000
TRS00255120 G	5.5	120	500/1000
TRS00255150 G	5.5	150	100/1000
TRS034819 XT	4.8	19	1000/4000
TRS034819 X	4.8	19	1000/4000
TRS035525 X	5.5	25	1000
TRS035535 X	5.5	35	1000
TRS035555 X	5.5	55	1000
TRS035565 X	5.5	65	250/1250
TRS035568 X	5.5	68	250/1250
TRS035575 X	5.5	75	200/250

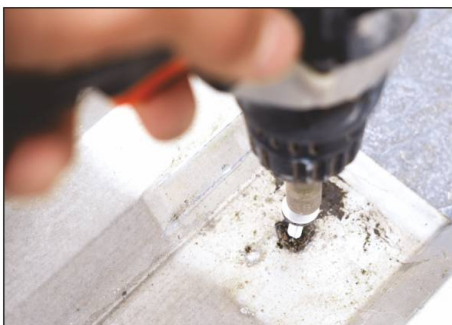

TFPL - YOUR TRUSTED PARTNER IN FABRICATION BUSINESS

UPVC AND ALUMINIUM DOOR/WINDOWS, FACADE



TNFA - NYLON WINDOW FRAME ANCHOR

Sleeve Material: Expansion sleeve made of premium grade nylon, promising a long lasting and secure grip. Screw made of premium carbon steel with mini 5 mm zinc coating, Stainless steel 304 (A2) & 316 (A4).

Base Material: Concrete, natural stone, ceramic solid and red brick, solid lime-sand brick, lightweight concrete, aerated concrete.

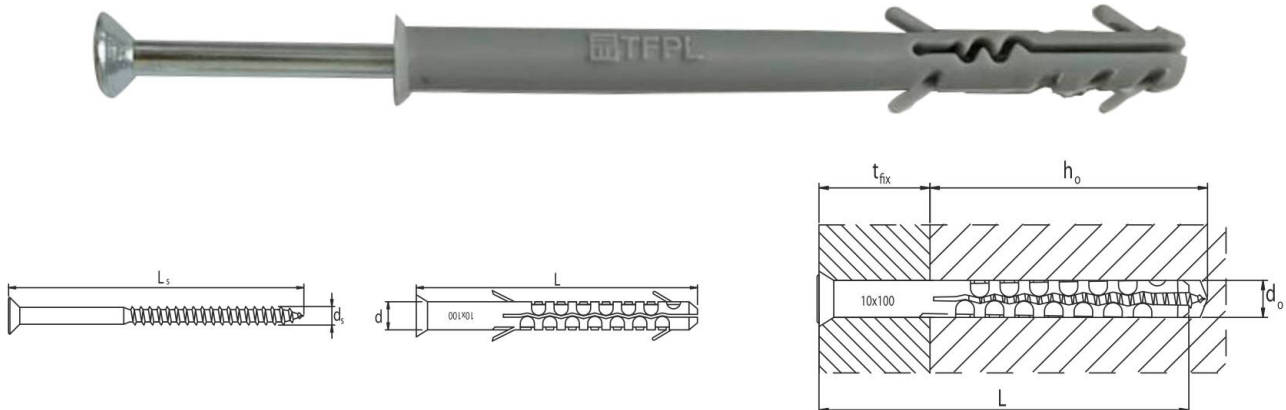

Screw material

- steel with 5 micron zinc.
- **stainless steel 304 grade/A2**

Applications

- fastening of beams, balustrades, window frames, door frames, wood battens.
- can be used in different types of base materials like, red brick, AAC blocks, concrete & lime and sand blocks etc.

Advantages

- nylon sleeve ensures durable and safe fastening,
- special sleeve shape prevents its rotation in the hole,
- resistance to extreme temperatures, from -40° to $+80^\circ\text{C}$.
- highest safety of fastening with plastic sleeves
- specially designed double fins and longer expansion zone gives a secure fitting.
- **stainless steel screw in the nylon anchor will increase the life of the fastener significantly**

Product code	Sleeve diameter [mm] d	Hole diameter [mm] d_0	Min hole depth [mm] h_0	Sleeve length [mm] L_0	Max. thickness of fixed element [mm] t_{fix}	Recommended tensile and shear capacity N_{rec}					
						Drive	Concrete C20/25 [kN] N_{rec}	Solid brick [kN] N_{rec}	Lime-sand brick [kN] N_{rec}	Light concrete [kN] N_{rec}	Aerated concrete [kN] N_{rec}
TNFA08060	8	60	40	60	30	PZ2	0.95	0.75	0.75	0.75	0.4
TNFA08080	8	80	50	100	30	PZ2	0.95	0.75	0.75	0.75	0.4
TNFA08100	8	100	50	100	30	PZ2	0.95	0.75	0.75	0.75	0.4
TNFA08120	8	120	50	120	30	PZ2	0.95	0.75	0.75	0.75	0.4
TNFA1080	10	80	50	120	30	PZ2	0.95	0.75	0.75	0.75	0.4
TNFA10100	10	100	50	100	30	PZ3	0.95	0.75	0.75	0.75	0.4
TNFA10120	10	120	50	120	30	PZ3	0.95	0.75	0.75	0.75	0.4
TNFA10140	10	140	50	140	30	PZ3	0.95	0.75	0.75	0.75	0.4
TNFA10160	10	160	50	140	30	PZ3	0.95	0.75	0.75	0.75	0.4

Also available in stainless steel 316 grade / A4 on customer demand

TNFA anchor installation scheme

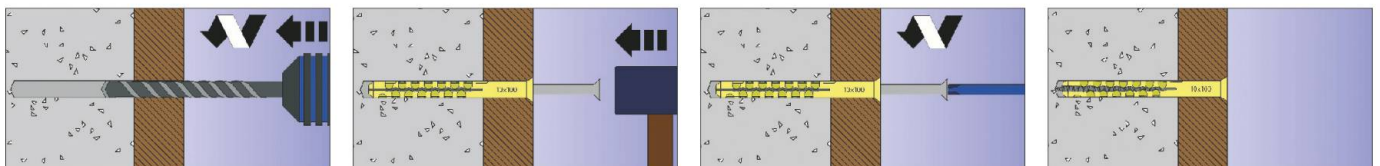

Trutek self drilling screws are used in UPVC window construction industry, connection of UPVC profile with the metal reinforcement of up to 2.5 mm is possible thus securing fittings on profiles.



Galvanized Steel, Cr⁶⁺ Coating

- Tapping screw thread

Applications

- fastening of steel sections to walls, floors and ceilings,
- fastening of metal and UPVC profiles with reinforcement material

Advantages

- Specially designed self drilling screws reduces the need of pre-drilling holes which results in reduction in time of various time consuming operations such as in roofing, cladding, etc.

Product Code	Screw Diameter (mm)	Screw Length (mm)	Drive	Box Packing	Bulk Packing
TWS03913CS	3.9	13	PH2	2000	12000
TWS03916CS	3.9	16	PH2	1000	6000
TWS03919CS	3.9	19	PH2	1000	6000
TWS03925CS	3.9	25	PH2	1000	6000
TWS04232CS	4.2	32	PH2	500	3000
TWS04238CS	4.2	38	PH2	500	3000
TWS04250CS	4.2	50	PH2	300	1800
TWS04860CS	4.8	60	PH2	1000	1000
TWS04875CS	4.8	75	PH2	500	500

▶ **SELF DRILL SCREWS - TRUSS HEAD**

Trutek self drilling Truss Head screws are used in UPVC window construction industry, connection of UPVC profile with the metal reinforcement of up to 3+ mm is possible and for securing fittings on profiles.



Galvanized steel, Cr⁶⁺ Coating

- Tapping screw thread

Applications

- Used for drilling and joining two metal plated of upto 3 mm as per DIN 7504 spec.
- Can be used to hold plastic profiles to metal reinforcement for lasting grip.

Advantages

- Trutek truss head screws are designed to perform optimally to drill through thick metal plates/ reinforcements.
- The head is modified to cover a larger area and give secure grip to the holding material.

Product Code	Screw Diameter (mm)	Screw Length (mm)	Drive	Box Packing	Bulk Packing
TWS04213TH	4.2	13	PH2	1000	6000/16000
TWS04216TH	4.2	16	PH2	1000	12000/13000
TWS04219TH	4.2	19	PH2	1000	12000
TWS04225TH	4.2	25	PH2	1000	16000
TWS04232TH	4.2	32	PH2	500	8000
TWS04238TH	4.2	38	PH2	500	8000

▶ WINDOW SCREWS - PREMIUM

Product Material: Trutek window screws comes with galvanised surface & PH drive system with diameters of 4.1 & 5mm. Special design of 4.1mm screws is used for secure fastening of hardware on soft window profile systems.

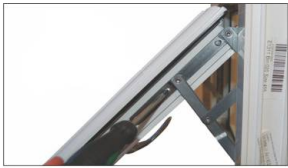

Product Code	Screw Diameter (mm)	Screw Length (mm)	Drive	Box Packing	Bulk Packing
TWS04113	4.1	13	PZ2	2000	12000
TWS04116	4.1	16	PZ2	1000	6000
TWS04119	4.1	19	PZ2	1000	6000
TWS04125	4.1	25	PZ2	1000	6000
TWS04132	4.1	32	PZ2	1000	6000
TWS04135	4.1	35	PZ2	1000	6000
TWS04138	4.1	38	PZ2	1000	6000

▶ WINDOW SCREWS - ECONOMIC

Product Material: Trutek chipboard screws comes with galvanised surface & PZ drive system with diameters of 4, 5 & 6mm respectively. Special design of these screws helps in coupling of windows.



Product Code	Screw Diameter (mm)	Screw Length (mm)	Drive	Box Packing	Bulk Packing
TWS00312	3	12	PZ2	2000	32000
TWS00316	3	16	PZ2	2000	32000
TWS00325	3	25	PZ2	2000	32000
TWS00413	4	13	PZ2	2000	32000
TWS00416	4	16	PZ2	1000	16000
TWS00420	4	20	PZ2	1000	16000
TWS00430	4	30	PZ2	1000	16000
TWS00435	4	35	PZ2	500	8000
TWS00438	4	38	PZ2	1000	16000
TWS00440	4	40	PZ2	1000	16000
TWS00450	4	50	PZ2	500	8000
TWS00470	4	70	PZ2	250	4000/8000
TWS0550	5	50	PZ2	500	4000/8000
TWS0560	5	60	PZ2	500	5000
TWS0570	5	70	PZ2	500	5000
TWS0575	5	75	PZ2	500	5000
TWS0580	5	80	PZ2	400	2400
TWS06100	6	100	PZ2	100	1500
TWS0835	8	35	PZ2	250	4000
TWS0850	8	50	PZ2	250	4000

Trutek stainless steel screws are available in 304 (A2) grade for connection of UPVC profile with the meta reinforcement and fixing of hardware without any worry. Available in both CSK and PAN heads.

Applications

- fixing of aluminium & UPVC, hardware,
- fixing of mosquito net,
- fixing of frames etc.



Advantages

- 304 grade screws gives long life to the UPVC/aluminium windows,
- easy to fix onto any kind of surface, because of availability in both CSK and PAN heads.



▶ CSK HEAD SCREWS

Product Code	Screw Diameter (mm)	Screw Length (mm)	Drive	Box Packing	Bulk Packing
TWS0695CSA2	6	9.5	PH2	2000	1200
TWS0613CSA2	6	13	PH2	1500	1500
TWS0616CSA2	6	16	PH2	1000	1200
TWS0619CSA2	6	19	PH2	2000	1200
TWS0895CSA2	8	9.5	PH2	2000	1200
TWS0813CSA2	8	13	PH2	2000	12000
TWS0816CSA2	8	16	PH2	1000	6000
TWS0819CSA2	8	19	PH2	1000	6000
TWS0825CSA2	8	25	PH2	1000	6000
TWS0832CSA2	8	32	PH2	500	6000
TWS0838CSA2	8	38	PH2	500	6000
TWS0850CSA2	8	50	PH2	500	500
TWS1038CSA2	10	38	PH2	500	500
TWS1050CSA2	10	50	PH2	250	250
TWS1075CSA2	10	75	PH2	200	500



▶ PAN HEAD SCREWS

Product Code	Screw Diameter (mm)	Screw Length (mm)	Drive	Box Packing	Bulk Packing
TWS0695PHA2	6	9.5	PH2	2000	12000
TWS0613PHA2	6	13	PH2	2000	12000
TWS0616PHA2	6	16	PH2	2000	12000
TWS0619PHA2	6	19	PH2	1000	12000
TWS0895PHA2	8	9.5	PH2	2000	12000
TWS0813PHA2	8	13	PH2	2000	12000
TWS0816PHA2	8	16	PH2	1000	6000
TWS0919PHA2	8	19	PH2	1000	6000
TWS0825PHA2	8	25	PH2	1000	6000
TWS0832PHA2	8	32	PH2	500	3000
TWS0838PHA2	8	38	PH2	500	3000
TWS0850PHA2	8	50	PH2	300	1800
TWS1038PHA2	10	38	PH2	300	300
TWS1050PHA2	10	50	PH2	250	1500

Note: S.S. 304 (A2) & 316 (A4) Screws, Nut & Bolts also available on requests.

▶ FASTENER CAP

Trutek fastener cap is used for covering the fastener hole onto the profile of the UPVC window or door.

Applications

- used for covering the hole and give elegant look to the UPVC window & doors.

Advantages

- easy to fit,
- special design prevents water and dust to enter into the UPVC section.
- made from high grade recycle nylon,
- milky white color blends with the profile color thus helping in maintaining overall looks of the window.



Product Code	Product Name	Box Packing	Bulk Packing
TPC03116	Fastener Screw Cap	1000/5000	1000/5000

▶ WEATHER STRIP

Trutek weather strip commonly known as wool pile is made from high quality wool strands to securely seal the gap between the two window sections.

Applications

- to close the gap between the window / door shutters thus helping in maintaining room temperature and keeping out dust, water & air through it.

Advantages

- high quality wool strands can with stand water / weathering and frictional rear - tear,
- available in many sizes to fit in various profile sections.



Product Code	Type	Base	Brush Height	Pack Size (Mtr/roll)	Pack Size (Mtr/Box)
TWP4806225S	Siliconised	4.8	6	225 mtrs. x 8 roll	2000 mtrs.
TWP4806250S	Siliconised	4.8	6	250 mtrs. x 8 roll	2000 mtrs.
TWP0606225M	Siliconised	6	6	250 mtrs. x 8 roll	2000 mtrs.
TWP6806225S	Siliconised	6.8	6	225 mtrs. x 8 roll	1800 mtrs.
TWP4806250NS	Non-Siliconised	4.8	6	250 mtrs. x 8 roll	2000 mtrs.
TWP0606250NS	Non-Siliconised	6	6	250 mtrs. x 8 roll	2000 mtrs.
TWP6806250	Non-Siliconised	6.8	6	225 mtrs. x 8 roll	1800 mtrs.
TWP6806250	Siliconised	6	6	500 mtrs. x 4 roll	-
TWP6806250	Siliconised	6	6	425 mtrs. x 4 roll	-

Trutek window profile packers are used for fixing of UPVC windows & doors by filling the gap between the frames & the wall. Made from high quality poly propylene

Applications

- for secure fitting of door & window frames,
- can we install immediately without chipping effect.

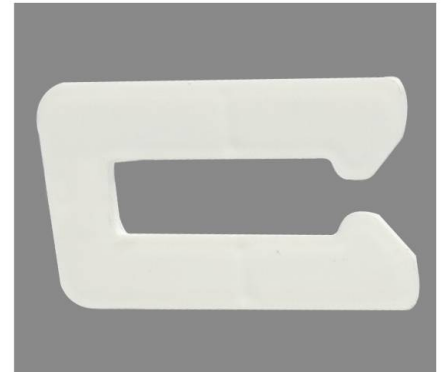
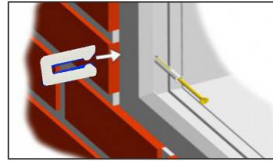

Advantages

- made from high grade recycled nylon, mixed with industrial grade plastic to give long life,
- lighter shades of the blocks, makes them easier to hide behind silicon filling,
- smartly designed open-ends, holds the fastener securely.

Product Code	Dimension (mm)	Thickness (mm)	Box Packing	Bulk Packing
TPP543315	54 x 33	1.5	1000	1000
TPP54333	54 x 33	3	1000	1000
TPP54335	54 x 33	5	500	500
TPP1053315	105 x 33	1.5	500	500
TPP105333	105 x 33	3	400	400
TPP105335	105 x 33	5	300	1000

▶ **WINDOW HARDWARE (GLASS & SLIDING GLASS PACKER)**

Applications

- for adjusting the height of the glass in the door and window frames.

Advantages

- available in both with rib & without rib for both sliding and non sliding systems,
- made from high grade recycled nylon mixed with industrial grade plastic to give long life support,

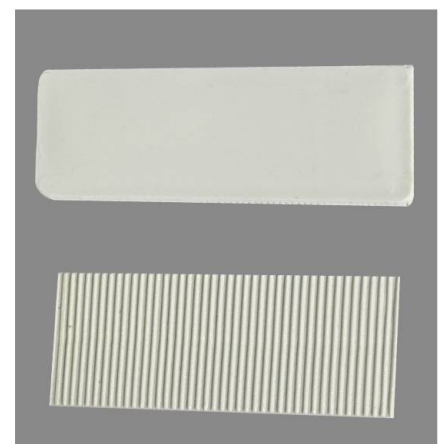
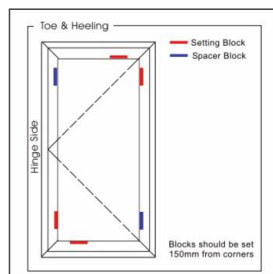

Product Code	Dimension (mm)	Thickness (mm)	Box Packing	Bulk Packing
TGP0622415	62 x 24	1.5	1000	1000
TGP062243	62 x 24	3	1000	1000
TGP062245	62 x 24	5	500	500
TSP062163	62 x 16	3	1000	1000
TSP06165	62 x 16	5	1000	1000
TSP06165	62 x 16	1.5	2000	2000

▶ HANDLE SCREWS

Product Material: Trutek Handle screws comes with galvanised surface & PH drive system with several diameters. Fits optimally with different hardwares, like handles, door locks etc.



Product Code	Screw Diameter (mm)	Screw Length (mm)	Drive	Box Packing	Bulk Packing
TFCSM530	M5	30	PH2	1000	3000
TFCSM540	M5	40	PH2	500	3000
TFCSM550	M5	50	PH2	400	3000
TFCSM565	M5	65	PH2	250	3000

▶ MECHANICAL L - JOINT

Product material: Trutek L-Joints are specially designed to join two separate uPVC sections securely at 90 degree.

Product Code	Product Description (mm)	Pack Size Box/Bulk (pcs.)
TLJ0112532	L-Joint 25 x 25 x 32	150/1500
TLJ01757502	L-Joint 75 x 75 x 20	120/1200
TLJ010020	L-Joint 100 x 100 x 20	50/500
TLJ010030	L-Joint 40 x 40 x 16	200/2000
TLJ010040	L-Joint 45 x 25 x 25	200/2000

Applications

- joining two separate uPVC sections mechanically with the helps of the screws



Advantages

- the L-joint has 2mm thickness along with a punch at the center which gives it a perfect strength to hold the window/doors tightly,
- tool grade carbon steel with 3 µm zinc coating gives a long life to the joint & thus increases the door/window span.

▶ BUMP STOPPER

Product material: Trutek Bump Stopper made from high grade plastic with metallic nut and superior cushion rubber section.

Product Code	Product Description (mm)	Pack Size Box/Bulk (pcs.)
TBS0219	Bump Stopper	500

Applications

- to stop sliding doors & windows from running away and preventing it from hitting the hard surface.



Advantages

- made from high quality plastic with long service life,
- black rubber cushion prevents noise produced when hit against the door/window section.
- in built metallic nut helps in tight fitting with the base material to ensure long lasting performance.
- milky white color blends with the profile color thus helps in maintaining the over all looks of the windows system.

▶ DRAINAGE CAP

Product material: Trutek Drainage Cap is made from high quality plastic to ensure better life & aesthetics when covered over the drainage hole of the uPVC door/windows.

Product Code	Product Description (mm)	Pack Size Box/Bulk (pcs.)
TDC3107	Drainage Cap-White	1000

Applications

- to securely cover the drain hole made for the water out flow during rains etc.



Advantages

- precise design helps in better fixing,
- high quality cap made of plastic,
- easy to fit,
- prevents dust, small insects from creeping through the opening,
- helps in maintaining overall looks of the windows.

▶ ANTI LIFT - SASH

Product Code	Product Description (mm)	Pack Size Box/Bulk (pcs.)
TAL0410S	Anti Lift - Sash	250



▶ ANTI LIFT

Product Code	Product Description (mm)	Pack Size Box/Bulk (pcs.)
TAL0425	Anti Lift	200



▶ DOOR UPVC SLIDING FIX STOPPER

Product Code	Product Description (mm)	Pack Size Box/Bulk (pcs.)
TFS0512S	Sliding Fix Stopper 12mm	1000



▶ DOOR UPVC FIX STOPPER

Product Code	Product Description (mm)	Pack Size Box/Bulk (pcs.)
TFS0525	Fix Stopper 12mm	500

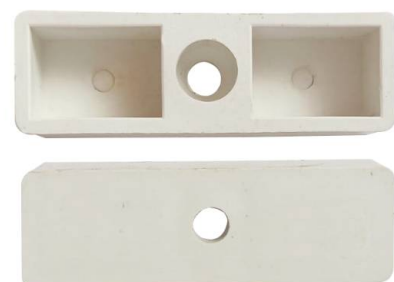

An ISO 9001 : 2015 Certified Company



TRUTEK FASTENERS PVT. LTD.

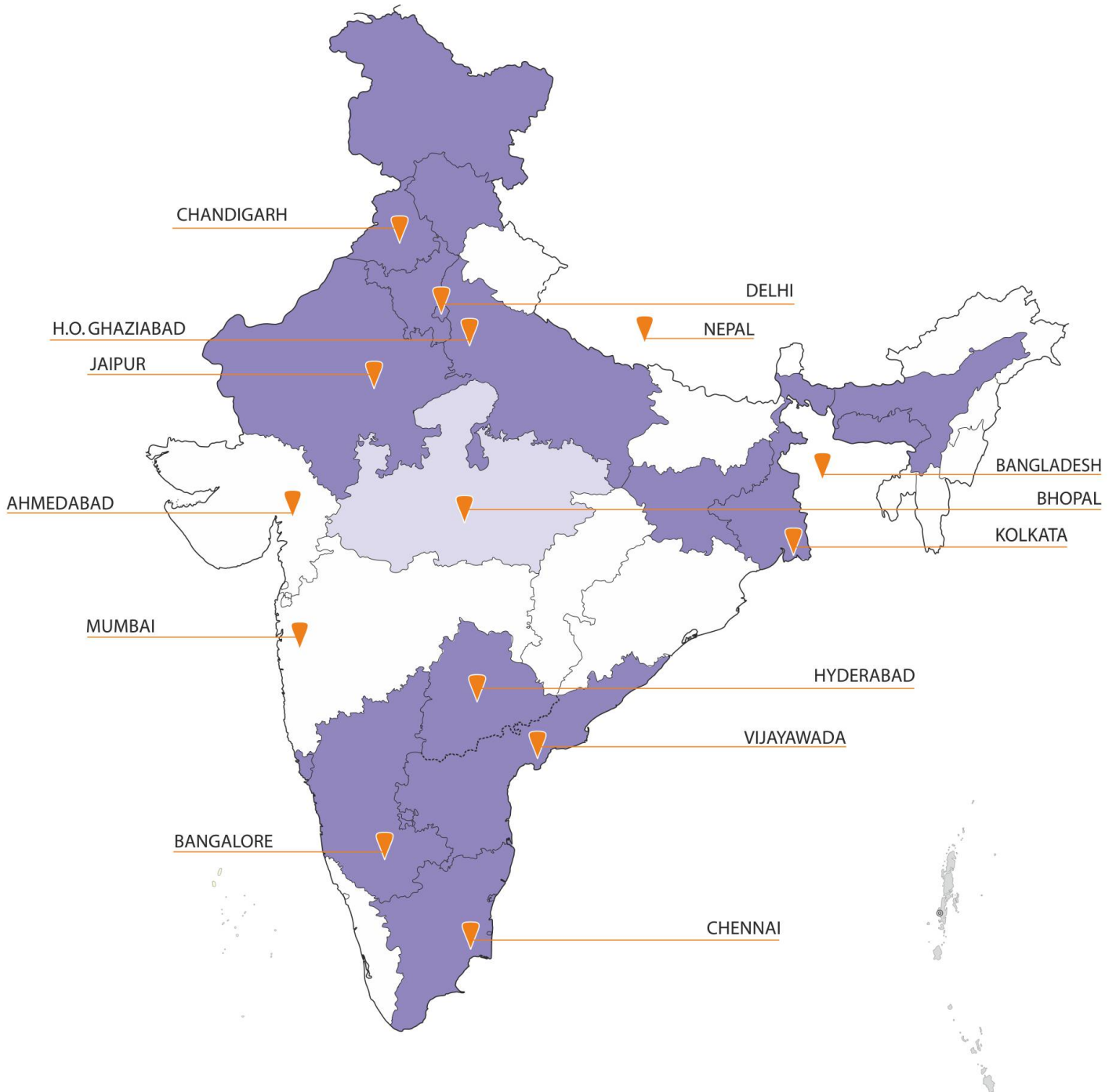

TFPL - Serving you in all the above locations and expanding fast across all major Indian cities through direct sales representation.

OUR MAJOR CLIENTS



दिल्ली मेट्रो रेल कॉर्पोरेशन लिमिटेड
Delhi Metro Rail Corporation Limited



LARSEN & TOUBRO



With an ever expanding product range to meet our customers' needs and exceed their expectations

An ISO 9001 : 2015 Certified Company



TRUTEK FASTENERS PVT. LTD.

Works : Plot No. E-80, EPIP, UPSIDC, Site-5, Kasna Greater Noida,
Uttar Pradesh-201310, INDIA

Reg. Office : B5/102, Krishna Apra Garden, Plot No. 7, Vaibhav Khand,
Indirapuram, Ghaziabad - 201010, U.P. (INDIA)